

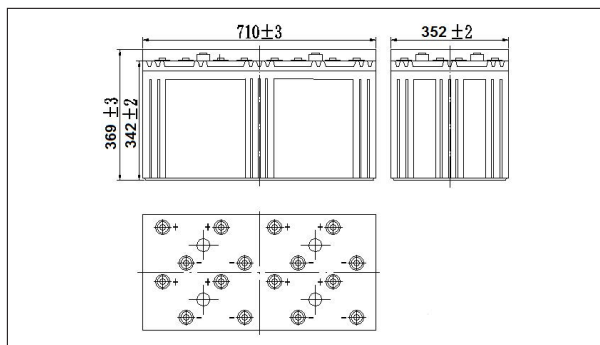

Specifications

| | | |
|-------------------------------|--------------------|--------------------|
| Nominal Voltage | 2V | |
| Rated capacity (10 hour rate) | 3000Ah | |
| Dimensions | Length | 710±3mm(27.95inch) |
| | Width | 352±2mm(13.86inch) |
| | Height | 342±2mm(13.46inch) |
| | Total Height | 369±2mm(14.53inch) |
| Approx. Weight | 191kg(420.2lbs)±3% | |

Outer dimensions (mm)



Terminal Type (mm)

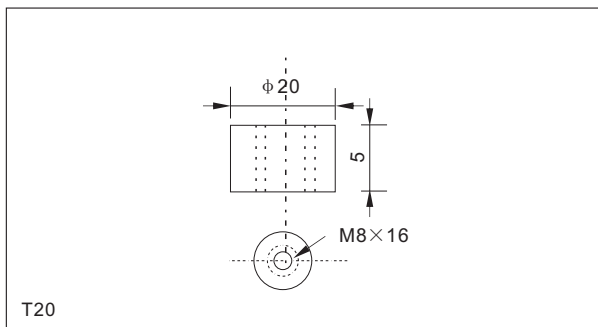

Characteristics

| | | |
|---|------------|--|
| Capacity (25°C) | 10HR(1.8V) | 3000Ah |
| | 3HR(1.80V) | 2250Ah |
| | 1HR(1.75V) | 1650Ah |
| Terminal type | | T20 |
| Internal resistance (Fully charged, 25°C) | | Approx. 0.13m Ω |
| Capacity affected by temperature (20HR) | 40°C | 102% |
| | 25°C | 100% |
| | 0°C | 85% |
| | -15°C | 65% |
| Self-discharge (25°C) | 3 months | Remaining Capacity: 91% |
| | 6 months | Remaining Capacity: 82% |
| | 12 months | Remaining Capacity: 65% |
| Nominal operating temperature | | 25°C ± 3°C (77°F ± 5°F) |
| Operating temperature range | Discharge | -15°C ~ 50°C (5°F ~ 122°F) |
| | Charge | -10°C ~ 50°C (14°F ~ 122°F) |
| | Storage | -20°C ~ 50°C (-4°F ~ 122°F) |
| Float charging voltage (25°C) | | 2.25 to 2.30V Temperature compensation: -3mV/°C |
| Cyclic charging voltage (25°C) | | 2.40 to 2.45V Temperature compensation: -5mV/°C |
| Maximum charging current | | 600A |
| Maximum discharge current | | 15000A (5 sec.) |
| Designed floating life (20°C) | | 18 years |

Construction

| Component | Positive plate | Negative plate | Container | Cover | Separator | Electrolyte | Safety valve | Terminal |
|--------------|----------------|----------------|-----------|-------|-----------|-------------|--------------|----------|
| Raw material | Lead dioxide | Lead | ABS | ABS | AGM | Gel | Rubber | Copper |

Constant Current Discharge Characteristics Unit: A (25°C, 77°F)

| F.V/Time | 30min | 60min | 2h | 3h | 4h | 5h | 6h | 8h | 10h | 20h | 24h |
|----------|-------|-------|------|-----|-----|-----|-----|-----|-----|-----|-----|
| 1.60V | 2610 | 1800 | 1081 | 783 | 618 | 514 | 453 | 361 | 305 | 160 | 138 |
| 1.65V | 2558 | 1764 | 1075 | 779 | 614 | 511 | 453 | 359 | 305 | 160 | 137 |
| 1.70V | 2480 | 1710 | 1065 | 773 | 610 | 508 | 447 | 356 | 304 | 160 | 137 |
| 1.75V | 2419 | 1674 | 1049 | 768 | 606 | 504 | 444 | 354 | 302 | 159 | 136 |
| 1.80V | 2331 | 1620 | 1022 | 753 | 588 | 489 | 431 | 343 | 300 | 158 | 135 |

Constant Power Discharge Characteristics Unit: W (25°C, 77°F)

| F.V/Time | 30min | 60min | 2h | 3h | 4h | 5h | 6h | 8h | 10h | 20h | 24h |
|----------|-------|-------|------|------|------|------|-----|-----|-----|-----|-----|
| 1.60V | 4881 | 3420 | 2086 | 1535 | 1212 | 1013 | 892 | 719 | 608 | 321 | 277 |
| 1.65V | 4783 | 3352 | 2074 | 1526 | 1204 | 1007 | 887 | 714 | 607 | 320 | 276 |
| 1.70V | 4637 | 3249 | 2055 | 1516 | 1196 | 1000 | 881 | 709 | 605 | 319 | 275 |
| 1.75V | 4524 | 3181 | 2025 | 1505 | 1188 | 993 | 875 | 704 | 601 | 317 | 274 |
| 1.80V | 4358 | 3078 | 1973 | 1475 | 1152 | 963 | 848 | 683 | 597 | 315 | 272 |

Note: The above characteristics data can be obtained within three charge or discharge cycles.

Discharge characteristics(25°C)

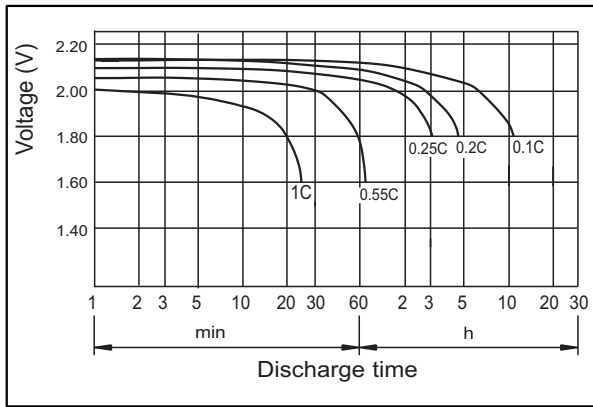

Charging characteristics

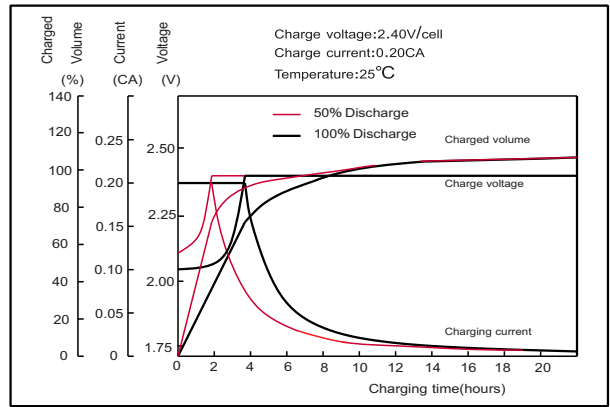

Effect of Temperature on Capacity

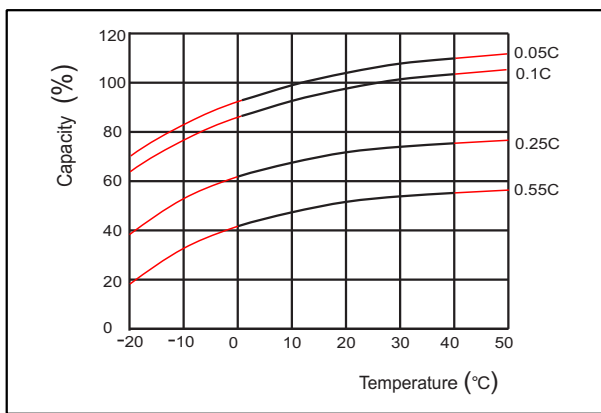

Self-discharge characteristics

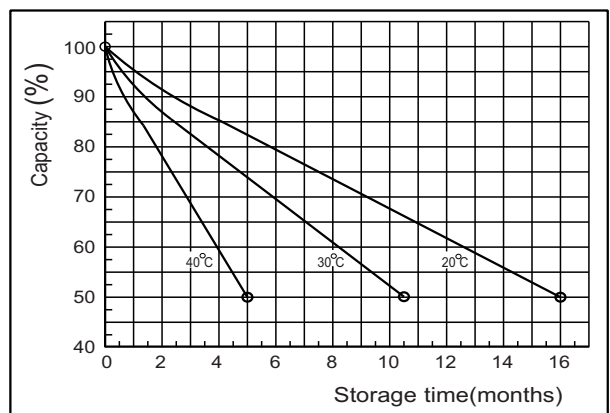

Temperature effects on float life

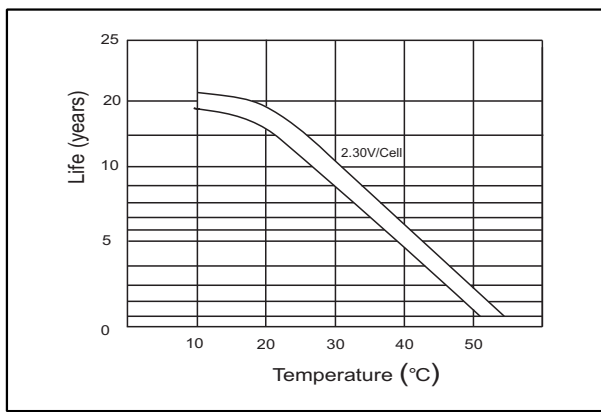

Cycle service life in relation to depth of discharge

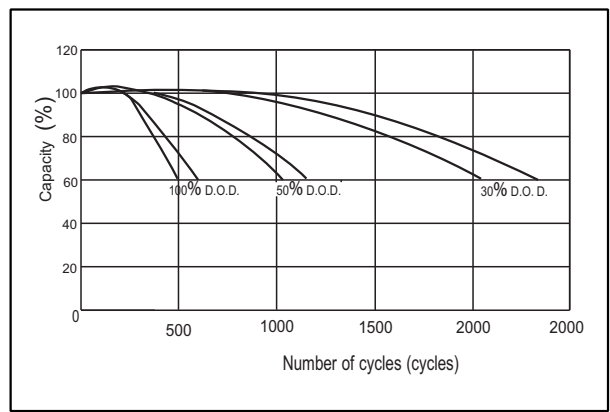

The relationship for OCV and Capacity (25°C)

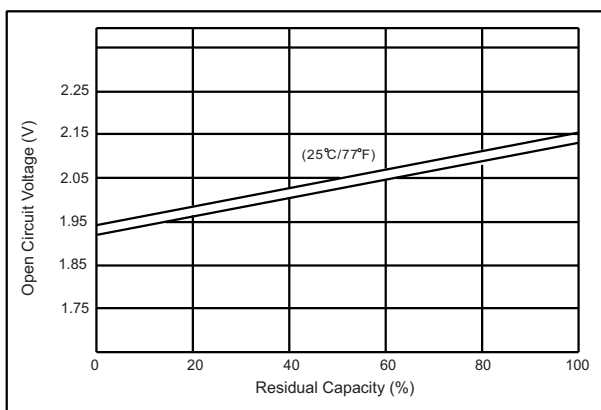

The relationship for Charging voltage and Temperature

